

"FOR LOCATION OF UTILITIES CALL 8-1-1 or 1-800-257-7777 OR LOG ON TO www.call811.com or http://www.missutility.net 48 HOURS IN ADVANCE OF ANY WORK IN THIS VICINITY"

The excavator must notify all public utility companies with underground facilities in the area of proposed excavation and have those facilities located by the utility companies prior to commencing excavation. The excavator is responsible for compliance with requirements of Chapter 36A of the Montgomery County Code.

Planning & Development Services
Received
4/14/2021

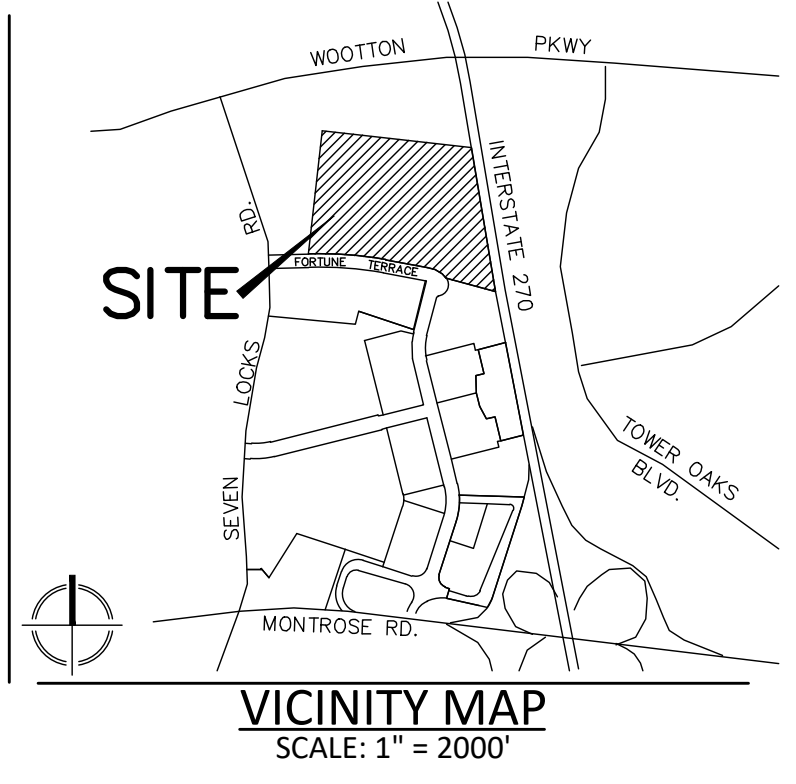

VIFA
ENGINEERS PLANNERS
LANDSCAPE ARCHITECTS SURVEYORS
VIFA MARYLAND, LLC
20251 CENTURY BOULEVARD SUITE #400
GERMANTOWN, MARYLAND 20874
PHONE: (301) 916-4100
FAX: (301) 916-2262
GERMANTOWN, MD. MCLEAN, VA.

APPLICANT:
FINMARC MANAGEMENT, INC.
7200 WISCONSIN AVE. SUITE 1100
BETHESDA, MD 20814
301.656.4111
MARC SOLOMON

SUBDIVIDER
EVA HOMES LLC
4800 HAMPDEN LANE SUITE 300
BETHESDA, MD 20814
301.634.8600
AARASH THAKKAR

ARCHITECTS
DEVEREAUX & ASSOCIATES
1477 CHAIN BRIDGE RD. SUITE 200
MCLEAN VA 22101
703.893.0102
BILL DEVEREAUX

SK & I
4600 EAST-WEST HIGHWAY
SUITE 700
BETHESDA, MD 20814
240.479.7491
DENNIS CONNERS

ATTORNEY
LINOWES & BLOCHER LLP
7200 WISCONSIN AVE. SUITE 800
BETHESDA MD, 20814
301.654.0504
SCOTT WALLACE

PLANNER & CIVIL ENGINEER
VIFA MARYLAND, LLC
20251 CENTURY BOULEVARD SUITE 400
GERMANTOWN MD, 20874
301.916.4100
SYLKE KNUPPEL, PE

REVISIONS	DATE

PROFESSIONAL SEAL

I HEREBY CERTIFY THAT THESE DOCUMENTS WERE PREPARED OR APPROVED BY ME, AND THAT I AM A DULY LICENSED PROFESSIONAL ENGINEER UNDER THE LAWS OF THE STATE OF MARYLAND. WILLIAM D. ROBINSON LICENSE No. 43113 EXPIRATION DATE 12/19/2020.

POTOMAC WOODS

LOT 23, BLOCK A
4TH ELECTION DISTRICT
MONTGOMERY COUNTY,
MARYLAND
WSSC GRID: 216NW08
TAX MAP: GQ23

LOTTING PLAN

PAM2020-00124

DRAWN BY: RMC
DESIGNED BY: RMC
DATE ISSUED: AUGUST 2020

VIFA
PROJECT
DRAWING NO. P 1 OF 1

SHEET NO.

